

Conquer your present.
Secure your
Future.

DREAMS DO COME TRUE



SECTOR - 88, GREATER FARIDABAD

higher education nearby

Within 10 Minutes

- Amrita Institute of Medical Sciences
- Lingaya's Institute of Management and Technology
- Echelon Institute of Technology
- Sudha Rustogi Dental College
- JB knowledge Park

Within 30 Minutes

- Manav Rachna University
- Jamia University
- Delhi University Colleges (3 Nos.)

schools nearby

Within 10 Minutes

- Delhi Public School
- Shiv Nadar School
- Modern School
- Aravali International School
- Shriram Millenium School
- Modern Delhi Public School
- Emerald Convent School
- Mother's Pride
- SRS International School
- Vidya Sanskar

Within 20 Minutes

- Delhi Public School - Sector 19
- Manav Rachna International School
- MVN School
- DAV Public School
- Holy CHild School
- Dynasty International
- Aravali International School
- Ryan International School

locational advantages...

Within 10 Minutes

- Delhi Border

Within 30 Minutes

- Nehru Place
- Hazrat Nizamuddin Railway Station

Within 60 Minutes

- Domestic Airport
- International Airport
- New Delhi Railway Station
- ISBT



OUR BANKERS : PUNJAB & SIND BANK

PROJECT APPROVED BY*

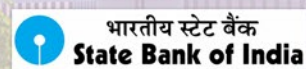

EMERALD HOMEDEVELOPERS PVT. LTD.

MARKETING OFFICE: EMERALD HOUSE, SECTOR - 88, KHERI ROAD, FARIDABAD - 121 001

THIS BROCHURE IS PURELY CONCEPTUAL & NOT A LEGAL OFFERING. FURTHER THE PROMOTERS/ARCHITECTS RESERVE THE RIGHT TO ADD/DELETE ANY DETAILS/SPECIFICATIONS/ELEVATIONS MENTIONED IF SO WARRANTED BY THE CIRCUMSTANCES. DGTPC HARYANA HAS GRANTED LICENSE NO. 124 OF 2008 DATED 14.06.2008 FOR DEVELOPMENT OF GROUP HOUSING COLONY ADMEASURING 30.268 ACRES IN VILLAGE PALWALI, BASELWA & KHERI KALAN, TEHSIL & DISTRICT FARIDABAD. THE LAYOUT/BUILDING PLANS APPROVED VIDE MEMO NO. - ZP-471/SD(DK)/2015/809-92 DATED 18-05-2015. BROCHURE : MAY' 2017. ALL LOANS ARE AT SOLE DISCRETION OF RESPECTIVE BANKS.

We Are Family

and

Together we shall be enjoying

Club House

Open Air Party Lounge Area

Swimming Pool

Gymnasium

Kids Zone - Before & After School

Swings and Slides

Jogging Track

Health and Fitness Area

Badminton Court

Basket Ball

Cricket Practice Pitch



“It’s not about the facility;
it’s about changing kids lives.
The facility is just the tool.”

**THE
AFTERSCHOOL
ZONE**



It is a happy talent to know how to play.



SITE PLAN







2BHK - 1260 SFT

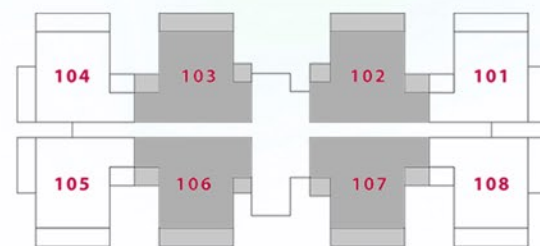

2BHK - 1310 SFT

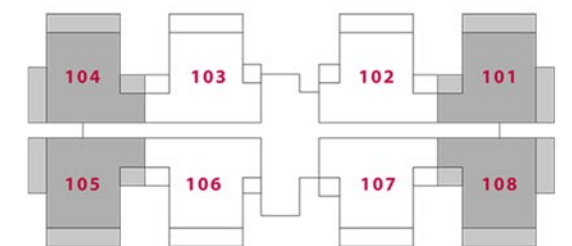

SPECIFICATIONS

STRUCTURE	Earthquake Resistant RCC Structure designed for the highest Seismic Consideration for Zone as Stipulated by the code and better safety.
FOUNDATION	Reinforced Concrete footings and column with raft.
LIVING/BEDROOMS	Flooring/ Skirting: Ceramic / Ceramic Glazed / Vitrified Tiles. Wall/Ceiling Finishes: Plastered and Painted with Pleasing shades of OBD.
TOILETS	Flooring: Ceramic Tiles. Wall/Ceiling Finishes: Ceramic Wall tiles up to dado level (approx. 2100 mm), above it OBD. Sanitary Ware: Wash Basin, EWC with Cisterns, CP Fittings, Provision for Hot & Cold Water System.
KITCHEN	Flooring/Skirting: Ceramic Tiles. Wall/Ceiling Finishes: Ceramic Tiles up to 2 feet height above counter and plastered and painted with pleasing shades of OBD. Platform: Pre polished Baroda Green marble or equivalent marble or Indian Stone. CP Fitting/Fixtures: Stainless Steel Sink, CP fittings, Provision for Hot & Cold Water System, provision for Geyser.
BALCONIES	Flooring: Vitrified / Ceramic Tiles. Wall/Ceiling Finishes: Exterior grade paint on plaster. Handrail and Parapets: Combination of Parapet. Walls and M.S. handrails as per functional and elevation requirements.
EXTERIOR WALL	External Wall Finishes: External grade anti fungal/anti algae paint from reputed makes and brands .
STAIRCASE	Flooring: Polished Indian Stone/Indian Marble on trends, raisers and landings. Railing: Polished/Painted M.S. Handrails and Balustrades. Wall Finishes: Oil Bound Distemper on Plaster.
COMMON PASSAGE	Flooring: Polished Indian Stone / Indian Marble / Tiles. Wall/Ceiling Finishes: Whitewash/ Oil Distemper on plaster.
DOORS/WINDOWS	Main Entrance Door: Painted/ Polished hardwood frame with polished / paint flush door shutters. Internal Entrance Door: Painted/ Polished Hardwood Frame with painted flush doors. Hardware: Locks, handles/knobs, MS/Steel/Brass hardware. Windows and External Glazing: Aluminum frame or UPVC frame windows with clear glass or equivalent.
ELECTRICAL PLUMBING	Fixtures and Fitting: ISI compliant modular switches / sockets, distribution boxes and circuit breakers from standard makes and brands. Wiring: ISI compliant copper wiring in concealed conduits. Adequate provisions for light points, fan points, receptacles and power points in all rooms. Electrical points for Exhaust Fans in Kitchens and Toilets. Plumbing: ISI compliant GI/CPVC/PPR water supply pipes with standard valves and accessories. ISI compliant PVC Waste Pipes and Traps or equivalent.
SECURITY SYSTEM	Single Gate 24 hours Security Guard

BE ASSURED OF



ESCALATION FREE RATES.



NO CHANGE IN COMMITTED SIZE OF FLAT.



FIRST FREE TRANSFER.



**ALL APPROVALS BY CONCERNED
AUTHORITIES FOR CONSTRUCTION.**